

**SUBMERGED PIPELINE CORRIDOR  
COORDINATE LOCATIONS**

POINT NO.	EASTING	NORTHING
1	3,750,710.0	554,545.6
2	3,750,250.3	554,034.3
3	3,750,696.3	553,646.8
4	3,750,861.2	553,877.2
5	3,751,313.3	553,568.7
6	3,752,363.0	553,473.3
7	3,758,068.2	553,474.6
8	3,762,771.7	555,071.0
9	3,774,282.9	557,608.3
10	3,775,319.0	557,827.1
11	3,774,717.8	558,402.3
12	3,773,723.8	558,181.7
13	3,762,671.3	555,687.4
14	3,758,067.9	554,060.5
15	3,752,735.1	554,077.0
16	3,751,484.1	553,964.5

**NOTE:**  
BATHYMETRIC SURVEY PREFORMED BY  
APTIM ON JUNE 2017 TO JANUARY 2018.  
ALL COORDINATES ARE IN STATE PLANE,  
NAD 1983, LOUISIANA SOUTH ZONE, U.S.  
SURVEY FEET.

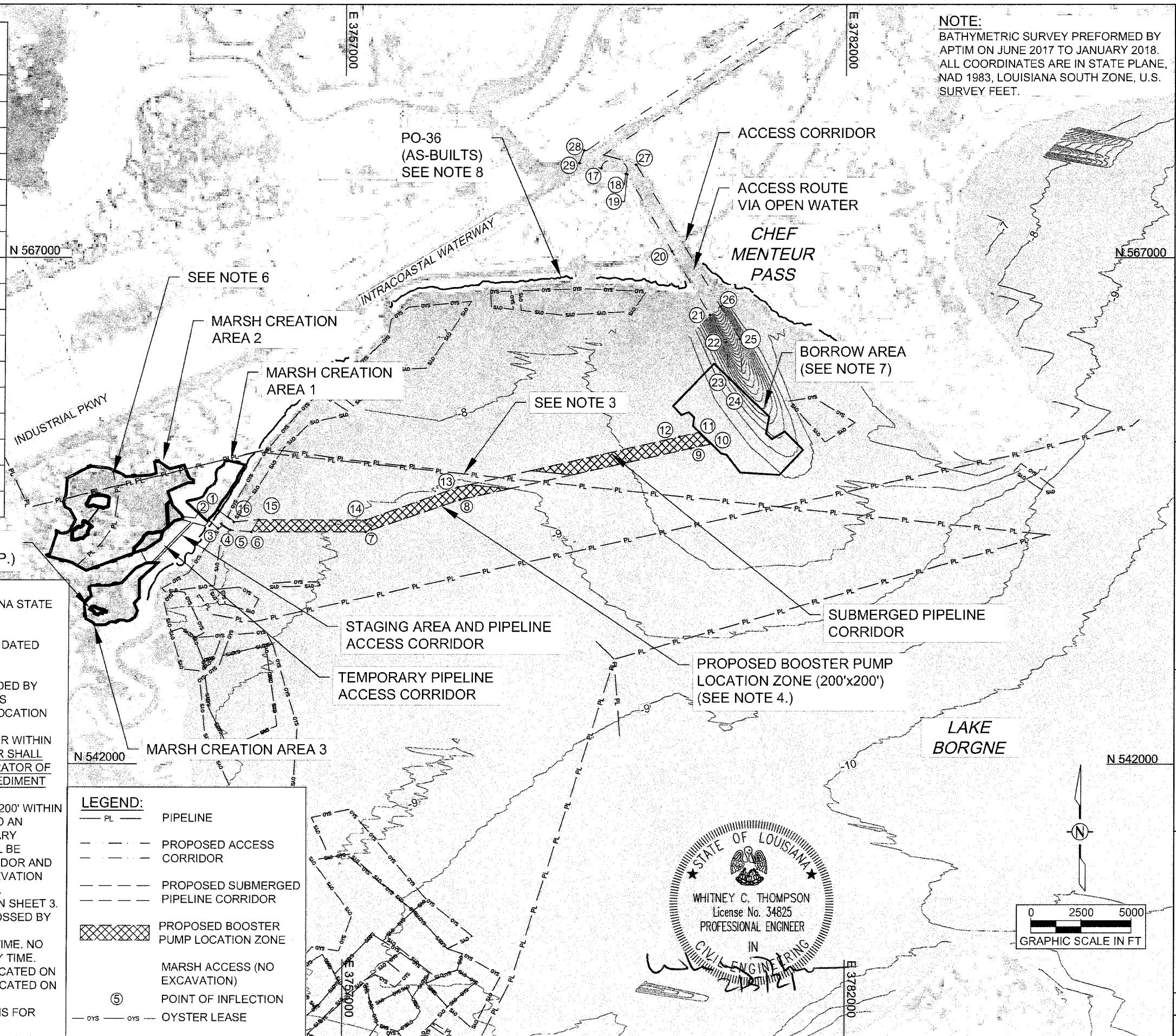

EARTHEN POND  
CONTAINMENT (TYP.)

- NOTES:**
- COORDINATES ARE IN FEET BASED ON THE LOUISIANA STATE PLANE COORDINATE SYSTEM, SOUTH ZONE, NORTH AMERICAN DATUM OF 1983 (NAD 83).
  - AERIAL PHOTOGRAPHY IS ESRI IMAGERY BASE MAP DATED NOVEMBER 2017.
  - LOCATIONS OF PIPELINES SHOWN IN PLANS ARE APPROXIMATE. PIPELINE LOCATIONS WERE PROVIDED BY INFRASTRUCTURE OWNERS, OR ARE FROM VARIOUS DATABASES. CONTRACTOR SHALL VERIFY EXACT LOCATION OF ALL PIPELINES WITHIN PROJECT AREA, ALONG CONVEYANCE CORRIDOR, WITHIN BORROW AREA, OR WITHIN WORK LIMITS PRIOR TO EXCAVATION. CONTRACTOR SHALL OBTAIN AN AGREEMENT WITH THE OWNER OR OPERATOR OF ANY PIPELINE TO BE CROSSED BY A SUBMERGED SEDIMENT PIPELINE OR TRACKED EQUIPMENT.
  - CONTRACTOR MAY EXCAVATE AN AREA UP TO 200'X200' WITHIN THE PROPOSED BOOSTER PUMP LOCATION ZONE TO AN ELEVATION OF -10' NAVD88 TO FACILITATE TEMPORARY PLACEMENT OF A BOOSTER PUMP. MATERIAL SHALL BE SIDECAST WITHIN THE SUBMERGED PIPELINE CORRIDOR AND GRADED TO WITHIN 0.5' OF PRE-CONSTRUCTION ELEVATION UPON DEMOBILIZATION. SEE SHEET 47 FOR DETAILS.
  - ACCESS CORRIDOR COORDINATES ARE LOCATED ON SHEET 3.
  - PBF ENERGY/COLLINS PIPELINE SHALL ONLY BE CROSSED BY EQUIPMENT OVER COMPOSITE MATTING. ONLY ONE VEHICLE/PIECE OF EQUIPMENT SHALL CROSS AT A TIME. NO EQUIPMENT SHALL STOP OVER THE PIPELINE AT ANY TIME.
  - BORROW AREA COORDINATES AND DETAILS ARE LOCATED ON SHEET 43. BORROW AREA CROSS SECTIONS ARE LOCATED ON SHEETS 44 AND 45.
  - SEE APPENDIX XX IN THE CONTRACT SPECIFICATIONS FOR PO-36 PROJECT DETAILS.

**LEGEND:**

— PL —	PIPELINE
- - - -	PROPOSED ACCESS CORRIDOR
- - - -	PROPOSED SUBMERGED PIPELINE CORRIDOR
XXXXXX	PROPOSED BOOSTER PUMP LOCATION ZONE
—	MARSH ACCESS (NO EXCAVATION)
⑤	POINT OF INFLECTION
- OYS -	OYSTER LEASE

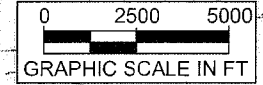
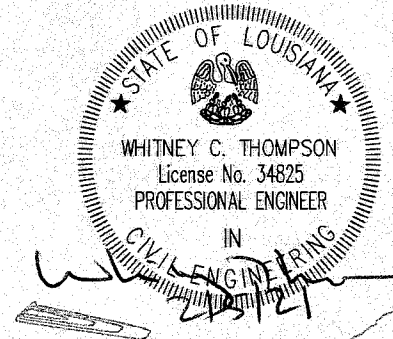

Southern Shores ENGINEERING Southern Shores Engineering, LLC Baton Rouge, Louisiana www.SouthernShoresEng.com		BY
COASTAL PROTECTION AND RESTORATION AUTHORITY 150 TERRACE AVENUE BATON ROUGE, LOUISIANA 70802		DATE
PROJECT OVERVIEW	DESIGNED BY: CP	REV.
GOLDEN TRIANGLE MARSH CREATION PROJECT	APPROVED BY: WT	DESCRIPTION
STATE PROJECT NUMBER: PO-0163	DRAWN BY: GK	
DATE: 02/05/2021		
SHEET 8 OF 47		